

## Rotating eyebolt APAL

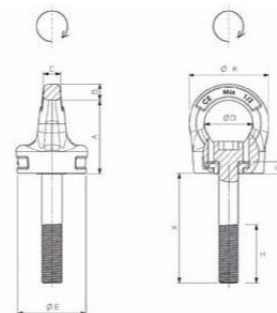

- Surub rotativ de ridicare cu inel cu lungime surub variabila, reglabil sub sarcina – APAL / Grad 10
- Punct de prindere cu fixare prin insurubare.
- Setul de chei de strangere se va comanda separat
- Setul de saiba DIN 6340 + piulita mare UNI 5587 cl10 se va comanda separat
- Punct de ancorare folosite pentru ridicarea sarcinilor cu trecere prin gauri si/ sau gauri oarbe filetate.
- Factor de siguranta 4 in toate directiile de tractiune
- Proiectat, testat si certificat in conformitate cu directivele tehnice GS-MO 1504 – EN 1677
- Potrivit pentru ridicarea în condiții de siguranță, în conformitate cu Directiva Mașini 2006/42/CE
- Poate fi orientat la 360°
- Testat la 100% magnaflux
- Testat la 20.000 cicluri
- Surubul cu cap cilindric si slot hexagonal cl. 10.9 cu lungime variabila in conformitate cu Directiva UNI5931 – DIN912.
- Va recomandam utilizarea unei saibe DIN 6340 cu dimensiuni corespunzatoare pentru a fi aplicata contra piulita.
- La tragerea axiala poate fi o variatie de + / -5 ° cu o scadere de 10% a capacitatii
- Daca surubul de ridicare cu inel trebuie fixat cu o piulita de blocare in timpul instalarii acesta trebuie sa fie mare si gaura trebuie sa fie pe partea ce trebuie ridicata cu un diametru maxim cu referire la diametrul nominal al surubului utilizat.
- Cand utilizati o contra piulita verificati ca odata instalate ambele baza dispozitivului cat si baza dispozitivului sunt total in contact cu suprafata piesei ce trebuie sa fie ridicate.



### DATE TEHNICE

Anchorage point used to lift loads with through holes and/or threaded dead holes.

- Safety coefficient 4 in all loading directions
- Designed, tested and certified in compliance with the technical directives GS-MO 1504 – EN 1677
- Suitable for safe lifting in compliance with the machinery directive 2006/42/EC
- Can be oriented at 360°
- Tested at 100 % magnaflux
- Tested at 20.000 stress cycles

- Cylinder head screw with hexagonal slot cl. 10.9 with variable length in compliance with directive UNI5931-DIN912

- We recommend the use of a washer DIN 6340 with appropriate dimensions to apply against the nut.

- On the axial pull there can be variation of +/-5° with a 10% decrease in capacity

- If the eyebolt is installed against the nut it has to be high and the through hole has to be on the part to be lifted with a diameter maximum with respect to the nominal diameter of the screw used

-When using a counter-nut, check that, once installed, both the base of the device and the base of the counter nut are totally in contact with the surface of the part to be lifted.

### Maße / Measurements

Artikel Article	Abmessung Size	s.w.l. / t	A	B	C	D	E	K	L
31708121	M 8	0,40	44,5	8	10,0	29	32	45	10,5
31710121	M 10	0,40	44,5	8	10,0	29	32	45	6,5
31712121	M 12	0,75	53,5	11	11,0	34	44	56	8,0
31716121	M 16	1,50	59,5	13	14,5	39	56	65	8,5
31720121	M 20	2,30	67,0	14	17,0	42	58	70	10,5
31724121	M 24	3,20	80,0	18	19,0	52	73	88	13,5
31730121	M 30	4,50	101,0	22	27,0	62	80	106	17,0

### Tragfähigkeiten / WLLs



Artikel Article	Abmessung DxL Size DxL	0°		90°		0°-45°		45°-60°		Asym.		Drehmoment Tightening couple Nm
		1Strang Single leg	2Stränge 2 legs	1Strang Single leg	2Stränge 2 legs	1Strang Single leg	2Stränge 2 legs	1Strang Single leg	2Stränge 2 legs	1Strang Single leg	2Stränge 2 legs	
31708121	M 8	1	2	0,30	0,6	0,42	0,30	0,30	0,63	0,45	0,30	8
31710121	M 10	1	2	0,40	0,8	0,56	0,40	0,40	0,84	0,60	0,40	16
31712121	M 12	2	4	0,75	1,5	1,00	0,75	0,75	1,60	1,12	0,75	28
31716121	M 16	4	8	1,50	3,0	2,00	1,50	1,50	3,15	2,25	1,50	70
31720121	M 20	6	12	2,30	4,6	3,22	2,30	2,30	4,83	3,45	2,30	135
31724121	M 24	8	16	3,20	6,4	4,48	3,20	3,20	6,70	4,80	3,20	230
31730121	M 30	12	24	4,50	9,0	6,30	4,50	4,50	9,40	6,70	4,50	465

Pozitie care este in conformitate cu coeficientul de siguranta 4 cat si cu directivele tehnice asociate

Punctul de ridicare nu poate fi utilizat cu surub de o lungime inadecvata ce previne fixarea corecta a dispozitivului – vezi diagrama pentru utilizare incorecta

Nu utilizati contrapiulita mai mica de 10.

Atentie: Dispozitivul nu este adecvat rotirii in timpul incarcarii

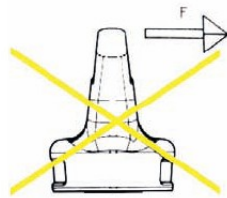

(Position which is in compliance with the safety coefficient 4 as per the related technical directives

The eyebolt cannot in any way be used with screws of an inappropriate length that prevent the correct fixing of the device - see diagram for non correct use

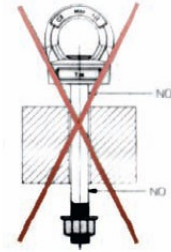

Do not use a counter-nut inferior to 10  
Warning : the device is not suitable for rotation during loading

d filett. standard	M 8	M 10	M 12	M 16	M 20	M 24	M 30
Max.	13,00	16,00	18,00	24,00	30,00	36,00	45,00
Max.	13,27	16,27	18,27	24,33	30,33	36,39	45,39
dk	Min.	12,73	15,73	18,73	23,67	29,67	44,61
Max.	8,00	10,00	12,00	16,00	20,00	24,00	30,00
K	Min.	7,64	9,64	11,57	15,57	19,48	29,48
Max.	8,00	10,00	12,00	16,00	20,00	24,00	30,00
ds	Min.	7,78	9,78	11,73	15,73	19,67	29,67
s nominale	6,00	8,00	10,00	14,00	17,00	19,00	22,00
e	Min.	6,68	9,15	11,43	16,00	19,44	25,15
H	28,00	32,00	36,00	44,00	52,00	60,00	72,00

I Nom	Ig Max.	Ig Max.	Ig Max.	Ig Max.	Ig Max.	Ig Max.	Ig Max.
12	3,75						
14	3,75						
16	3,75	4,5					
18	3,75	4,5	5,25				
20	3,75	4,5	5,25				
22	3,75	4,5	5,25				
25	3,75	4,5	5,25	6			
30	3,75	4,5	5,25	6	7,5		
35	3,75	4,5	5,25	6	7,5		
40	12,00	4,5	5,25	6	7,5	9	
45	17,00	13,0	5,25	6	7,5	9	10,5
50	22,00	18,0	5,25	6	7,5	9	10,5
55	27,00	23,0	19,00	6	7,5	9	10,5
60	32,00	28,0	24,00	6	7,5	9	10,5
65	37,00	33,0	29,00	21	7,5	9	10,5
70	42,00	38,0	34,00	26	7,5	9	10,5
75	47,00	43,0	39,00	31	23,0	9	10,5
80	52,00	48,0	44,00	36	28,0	9	10,5
85	57,00	53,0	49,00	41	33,0	9	10,5
90	62,00	58,0	54,00	46	38,0	30	10,5
100	72,00	68,0	64,00	56	48,0	40	10,5
110	82,00	78,0	74,00	66	58,0	50	38,0
120	92,00	88,0	84,00	76	68,0	60	48,0
130	102,00	98,0	94,00	86	78,0	70	58,0
140	112,00	108,0	104,00	96	88,0	80	68,0
150	122,00	118,0	114,00	106	98,0	90	78,0
160	132,00	128,0	124,00	116	108,0	100	88,0
180	152,00	148,0	144,00	136	128,0	120	108,0
200				156	148,0	140	128,0
220				176	168,0	160	148,0
240				196	188,0	180	168,0

Für die effektive Berechnung der Schraubenlänge sprechen Sie uns bitte an.  
Please contact us for the calculation of the effective length of the screw.



Artikel Article	Abmessung Size
317S08AL	M 8
317S10AL	M 10
317S12AL	M 12
317S16AL	M 16
317S20AL	M 20
317S24AL	M 24
317S30AL	M 30



Artikel Article	Abmessung Size
317M08AL	M 8
317M10AL	M 10
317M12AL	M 12
317M16AL	M 16
317M20AL	M 20
317M24AL	M 24
317M30AL	M 30

Total Race Impex SRL J40/20761/2006 , RO 19794573 , Bucuresti, sector 6 , Bulevardul Uverturii , nr.69A, cod:060933 Mobil:0728305610/ 0728305611 / 0728305612; fax: 0214301206;tel/fax :0314201202 E-mail:info@totalrace.ro;vanzari@totalrace.ro  
Website:www.totalrace.ro , www.lanturideridicare.ro , www.chingimacarale.ro, www.benziambalare.ro, www.banadaancorare.rowww.lanturichingi.ro , www.carligemacarale.ro , www.echipamentemacara.ro, www.benebeton.ro, www.clestiridicare.ro .



Copyright © 2010 TOTAL RACE IMPEX SRL . Toate Drepturile Rezervate ® Designed by Ruxandra Ionescu